

FORM NO. 1.

Courses & distances down Spruce Creek
from the post to the Hy Stump.

5 26 W 41
5 83 W 22
5 80 W 28 Hy Stump.
91

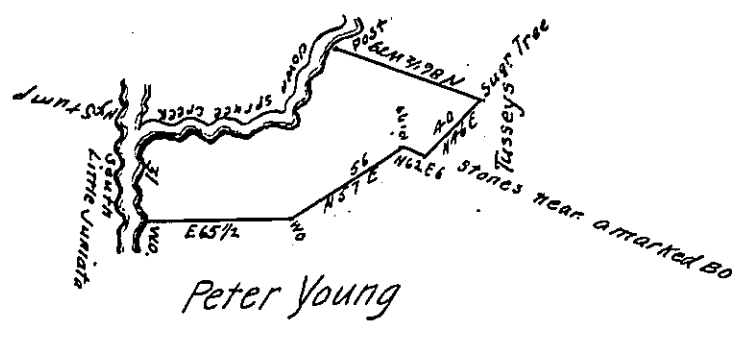

Situate in Franklin Township Hurlingham County Containing 28^{as} 153 p^s and
the Usual Allowance for Roads. Surveyed the 28th day of May 1791 in pursuance of
a Warrant to Abraham Sells dated the 22^d Day of February 1785.

To Daniel Brodhead Esquire S.G. John Carran D.S.

IN TESTIMONY that the above is a copy of the original remaining on file in
the Department of Internal Affairs of Pennsylvania, made
comformably to an Act of Assembly approved the 16th day of
February 1833, I have hereunto set my hand and caused
the Seal of said Department to be affixed at Harrisburg,
this ninth day of January 1907

Isaac R. Brown
Secretary of Internal Affairs.